

© 2014 - GZA GeoEnvironmental, Inc. GZA-1\152100to152199\152160.70-MINNESOTA VALLEY SAND\DRAWINGS\AutoCAD\COUNTY MAPS.dwg [FIG 9] June 29, 2015 - 1:44pm kara.kunz

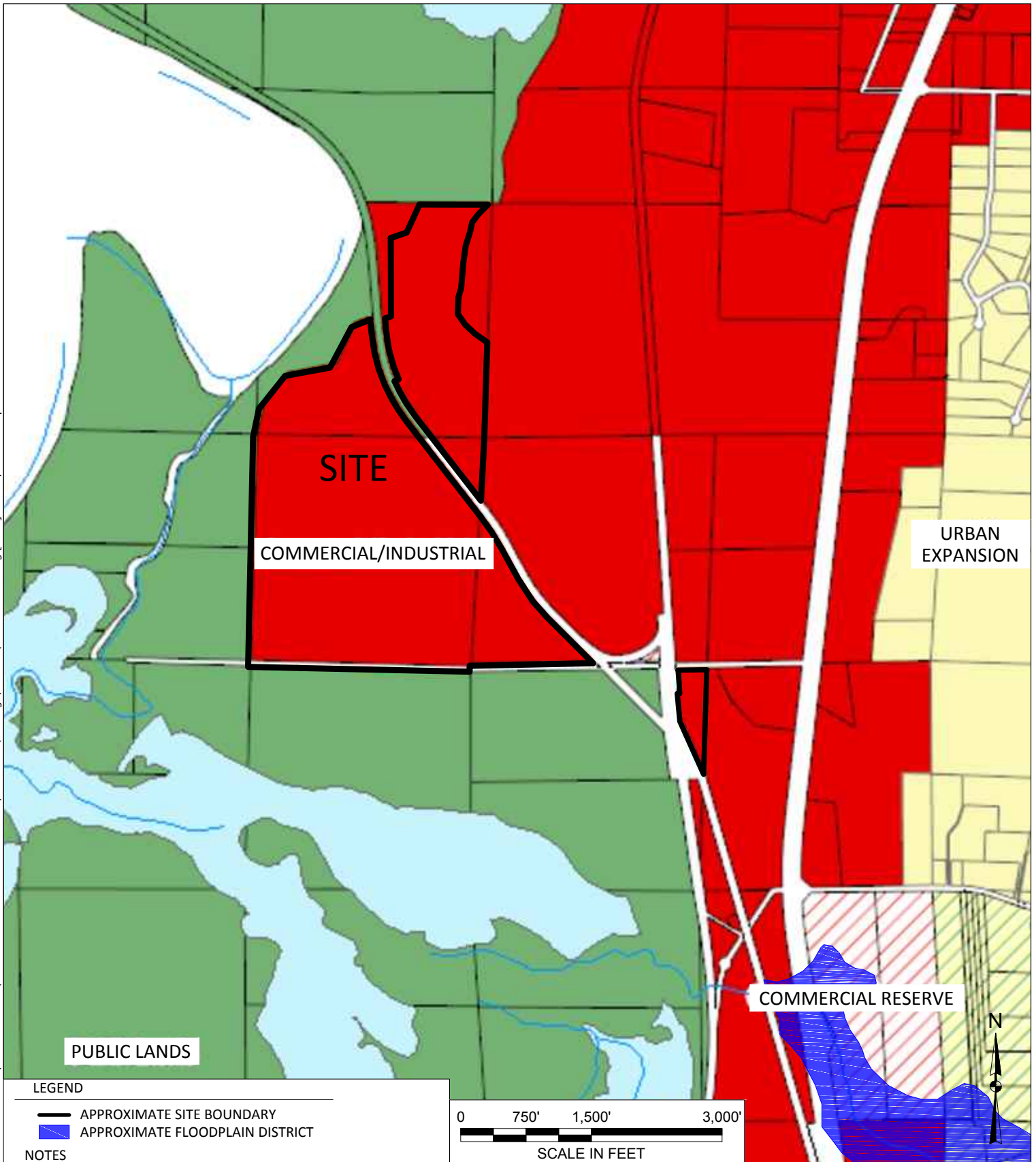

**PUBLIC LANDS**

**COMMERCIAL/INDUSTRIAL**

**URBAN EXPANSION**

**COMMERCIAL RESERVE**

**LEGEND**

- APPROXIMATE SITE BOUNDARY
- APPROXIMATE FLOODPLAIN DISTRICT

**NOTES**

1. BASE MAP DEVELOPED FROM THE LOCAL COUNTY ONLINE GIS MAPPING TOOL. THE PROGRAM NOTES THAT ALL PROPERTY BOUNDARIES ARE NOT SURVEYED AND ARE ONLY APPROXIMATE REPRESENTATION OF ACTUAL BOUNDARIES.

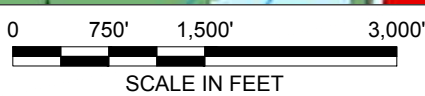

UNLESS SPECIFICALLY STATED BY WRITTEN AGREEMENT, THIS DRAWING IS THE SOLE PROPERTY OF GZA GEOENVIRONMENTAL, INC. (GZA). THE INFORMATION SHOWN ON THE DRAWING IS SOLELY FOR USE BY GZA'S CLIENT OR THE CLIENT'S DESIGNATED REPRESENTATIVE FOR THE SPECIFIC PROJECT AND LOCATION IDENTIFIED ON THE DRAWING. THE DRAWING SHALL NOT BE TRANSFERRED, REUSED, COPIED, OR ALTERED IN ANY MANNER FOR USE AT ANY OTHER LOCATION OR FOR ANY OTHER PURPOSE WITHOUT THE PRIOR WRITTEN CONSENT OF GZA. ANY TRANSFER, REUSE, OR MODIFICATION TO THE DRAWING BY THE CLIENT OR OTHERS, WITHOUT THE PRIOR WRITTEN EXPRESS CONSENT OF GZA, WILL BE AT THE USER'S SOLE RISK AND WITHOUT ANY RISK OR LIABILITY TO GZA.

PREPARED BY:  
**GZA GeoEnvironmental, Inc.**  
**Engineers and Scientists**  
 20900 SWENSON DRIVE, SUITE 150  
 WAUKESHA, WISCONSIN 53186  
 (262) 754-2560

PREPARED FOR:  
**FAIRMOUNT SANTROL**

PROJ MGR: MJK    REVIEWED BY: MJK  
 DESIGNED BY: CR    DRAWN BY: KLK

NO.	ISSUE/DESCRIPTION	BY	DATE
<p><b>SCOTT COUNTY ZONING MAP EXCERPT</b></p> <p>SCOPING EAW                      MINNESOTA VALLEY SAND                      SHAKOPEE, MINNESOTA</p>			
		<p>FIGURE <b>9</b></p>	
		<p>SHEET NO.</p>	
		<p>REVISION NO.</p>	
		<p>PROJECT NO. 20.0152160.70</p>	
		<p>DATE 4/9/15</p>	
		<p>SCALE: NOT TO SCALE</p>	